

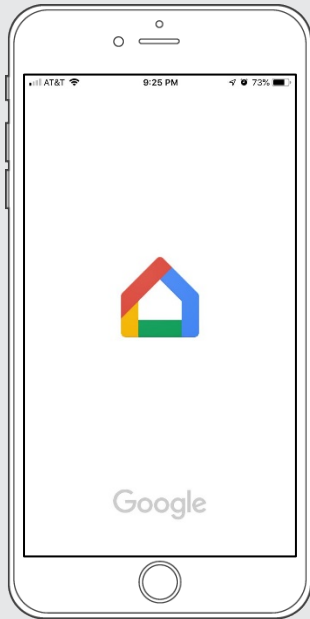

# QUICK START GUIDE – GOOGLE HOME

## STEP 1



Open the "Google Home" mobile App.

## STEP 2

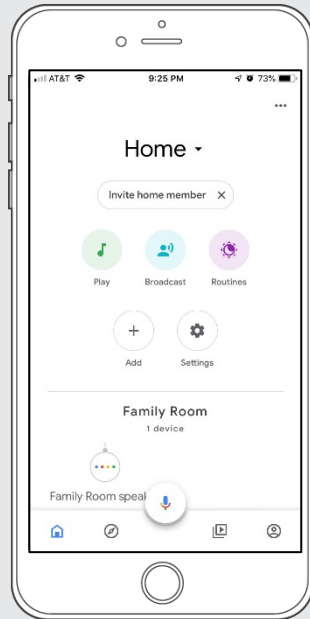

From the Home Screen, select "+" icon

## STEP 3

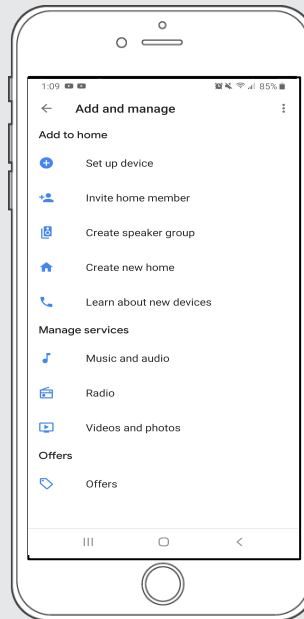

From that list, select "Set up device"

## STEP 4

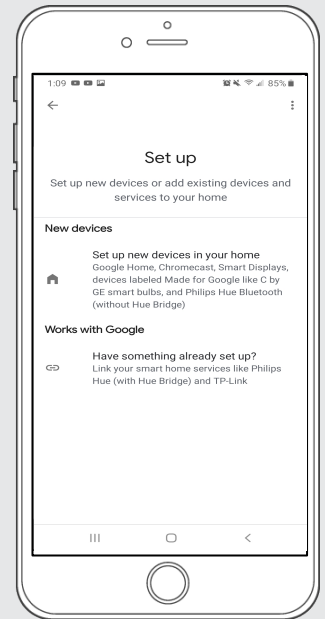

Next, select "Have something already set up"

## STEP 5

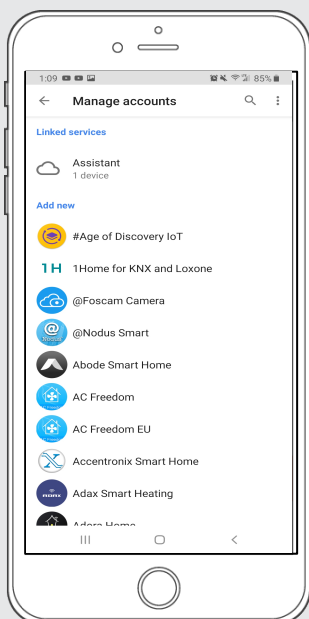

Click the 'Search' and type in: "Smart Home Collection"

## STEP 6

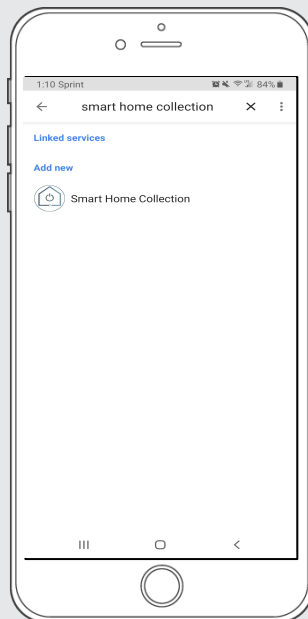

Click on the SHC logo

## STEP 7

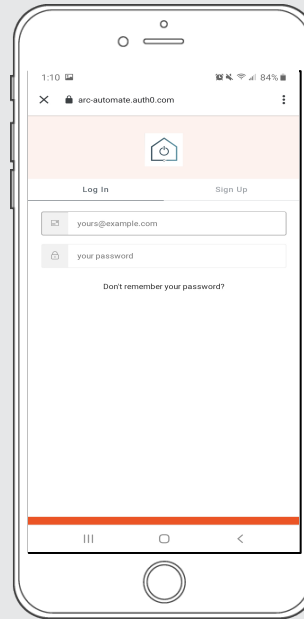

Login with your SHC App Credentials

## STEP 8

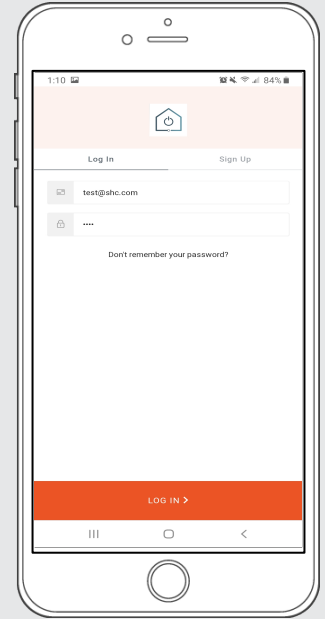

Account has been linked!



# How to Operate the Shades

## STEP 9

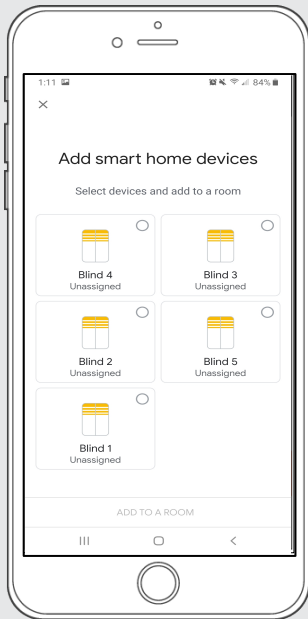

Your shades from the SHC app will show up here

## STEP 10



On this screen you can choose a device

## STEP 11

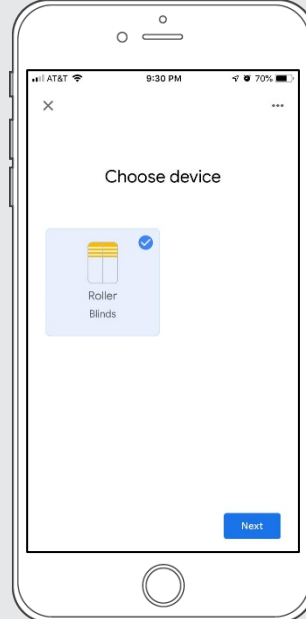

Select the desired shade that you want to include in the Google Home.

## STEP 12

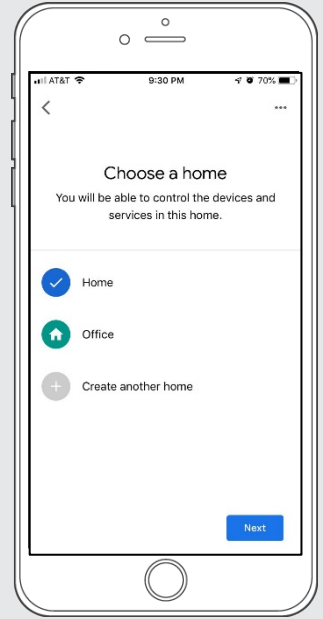

Select the appropriate Home for your shades.

## STEP 13

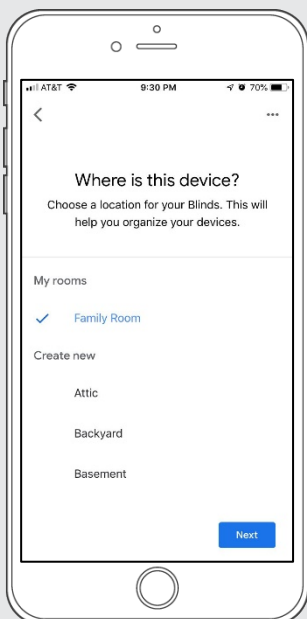

Choose the location that your shade is located .

## STEP 14

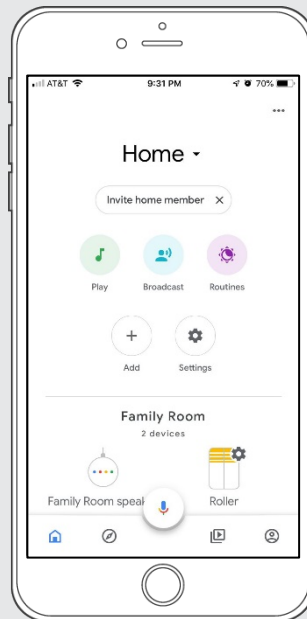

Click on the shade to customize the information in the Google Home App.

## STEP 15

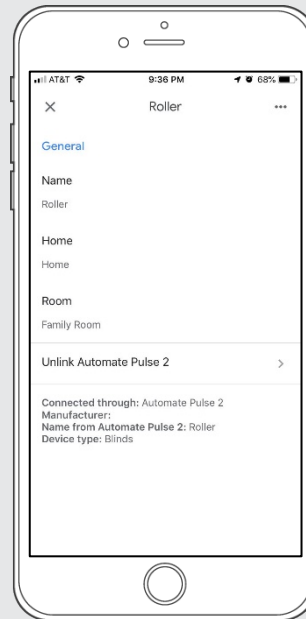

If desired, change the shade information in the Google Home App accordingly

## STEP 16

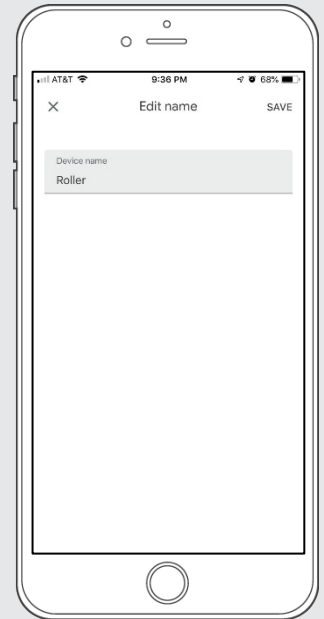

Click in the Name, if you want change the Shade Name on the Google Home.

### STEP 17

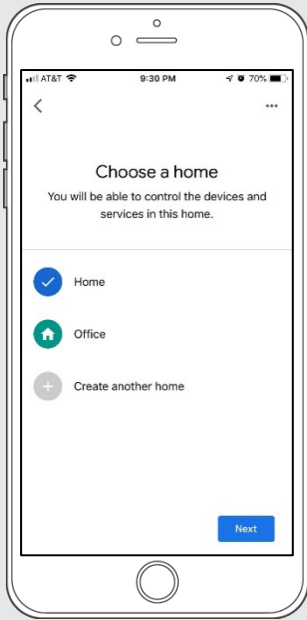

If its desired, change the Home location for your shades.

### STEP 18

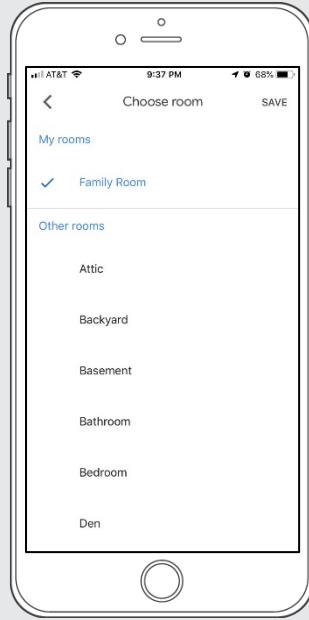

Select a new location that your Google Home is associated.

### STEP 19

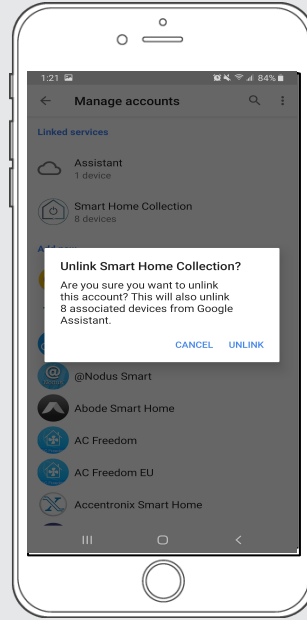

If its desired, unlink the SHC hub from your Google Home App.

# How to Control your Shades using “Google Home”

The Google Home App allows you use the Voice control through your iPhone, iPad, iWatch or any Android device.

You just need to Say, "Hey Google" and followed by ...

- Close <blinds name>
- Close <room name> blinds
- Close <blinds nick name>
- Set <blinds names> to <percentage>
- Close <blinds name> <adverb>
- Close <blinds name> <direction>
- Close blinds halfway
- Open blinds halfway
- Open <blinds name>
- Open <Room Name> Blinds
- Open <blinds nick name>
- Open <blinds names> to <percentage>
- Open <blinds name> <adverb>
- Open <blinds name> <direction>
- Set <blinds name> <percentage>
- Are <blinds name> open?
- Rotate <blinds name> to <degrees>
- Rotate <blinds name> to <percentage>
- Rotate <blinds name> <degrees> clockwise
- Rotate <blinds name> <degrees> counterclockwise

